

eIC5154

IN-CEILING LOUDSPEAKERS

EN 54-24 Certified In-ceiling / In-wall Loudspeaker



USER MANUAL

INDEX

1. IMPORTANT REMARK	3
2. IMPORTANT SAFETY INSTRUCTIONS	3
3. IMPORTANT NOTE	5
4. INTRODUCTION	5
<i>Applications</i>	5
5. MAIN CHARACTERISTICS:	5
6. CONNECTION	6
7. INSTALLATION	7
8. TECHNICAL DATA	8
<i>Circuit diagram</i>	8
<i>Mechanical diagrams</i>	9
<i>Exploded view</i>	9
<i>Rear label</i>	10
<i>Certification plate</i>	10

1. IMPORTANT REMARK



WARNING: SHOCK HAZARD - DO NOT OPEN
AVIS: RISQUE DE CHOC ÉLECTRIQUE - NE PAS OUVRIR



The lightning flash with arrowhead symbol, within an equilateral triangle, is intended to alert the user to the presence of uninsulated “dangerous voltage” within the product’s enclosure that may be of sufficient magnitude to constitute a risk of electric shock to persons.



The exclamation point within an equilateral triangle is intended to alert the user to the presence of important operating and maintenance (servicing) instructions in the literature accompanying the appliance.

WARNING (If applicable): The terminals marked with symbol of “” may be of sufficient magnitude to constitute a risk of electric shock. The external wiring connected to the terminals requires installation by an instructed person or the use of ready-made leads or cords.

WARNING: To prevent fire or shock hazard, do not expose this equipment to rain or moisture.

WARNING: An apparatus with Class I construction shall be connected to a mains socket-outlet with a protective earthing connection.

2. IMPORTANT SAFETY INSTRUCTIONS

1. Read these instructions.
2. Keep these instructions.
3. Heed all warnings.
4. Follow all instructions.
5. Do not use this apparatus near water.
6. Clean only with dry cloth.
7. Do not block any ventilation openings. Install in accordance with the manufacturer’s instructions.
8. Do not install near any heat sources such as radiators, heat registers, stoves, or other apparatus (including amplifiers) that produce heat.

9. Do not defeat the safety purpose of the polarized or grounding type plug. A polarized plug has two blades with one wider than the other. A grounding type plug has two blades and a third grounding prong. The wide blade or the third prong are provided for your safety. If the provided plug does not fit into your outlet, consult an electrician for replacement of the obsolete outlet.
10. Protect the power cord from being walked on or pinched particularly at the plugs, convenience receptacles, and at the point where they exit from the apparatus.
11. Only use attachments/accessories specified by the manufacturer.
12. Unplug the apparatus during lightning sorts or when unused for long periods of time.
13. Refer all servicing to qualified personnel. Servicing is required when the apparatus has been damaged in any way, such as power supply cord or plug is damaged, liquid has been spilled or objects have fallen into the apparatus, the apparatus has been exposed to rain or moisture, does not operate normally, or has been dropped.
14. Disconnecting from mains: When switching off the POWER switch, all the functions and light indicators of the unit will be stopped, but fully disconnecting the device from mains is done by unplugging the power cable from the mains input socket. For this reason, it always shall remain easily accessible.
15. Equipment is connected to a socket-outlet with earthing connection by means of a power cord.
16. The marking information is located at the bottom of the unit.
17. The apparatus shall not be exposed to dripping or splashing and that no objects filled with liquids, such as vases, shall be placed on apparatus.

NOTE: *This equipment has been tested and found to comply with the limits for a Class A digital device, pursuant to part 15 of the FCC Rules. These limits are designed to provide reasonable protection against harmful interference when the equipment is operated in a commercial environment. This equipment generates, uses, and can radiate radio frequency energy and, if not installed and used in accordance with the instruction manual, may cause harmful interference to radio communications. Operation of this equipment in a residential area is likely to cause harmful interference in which case the user will be required to correct the interference at his own expense.*



WARNING: This product must not be discarded, under any circumstance, as unsorted urban waste. Take to the nearest electrical and electronic waste treatment centre.

NEEC AUDIO BARCELONA, S.L. accepts no liability for any damage that may be caused to people, animal or objects due to failure to comply with the warnings above.

3. IMPORTANT NOTE

Thank you for choosing our Ecler **eIC5154 EN 54-24 certified in-ceiling/in-wall loudspeaker!**

It is **VERY IMPORTANT** to carefully read this manual and to fully understand its contents before any connection in order to maximize your use and get the best performance from this equipment.

To ensure optimal operation of this device, we strongly recommend that its maintenance be carried out by our authorised Technical Services.

Ecler **eIC5154** comes with a **3-year warranty**.

4. INTRODUCTION

ECLER eIC5154 is a cost-effective in-ceiling loudspeaker that features a design which conforms to EN54-24 standard (Fire detection and fire alarm systems, Voice alarms - Loudspeakers). It performs a 5"woofer.

Applications

- Corporate and residential buildings
- Commercial premises
- Leisure centres
- Health and sports centres
- Meeting and conference rooms
- Auditoriums, museums

5. MAIN CHARACTERISTICS:

- One-way ABS speaker
- Power selector @ 100V 6/3/1,5/0,75/0,38 W
- 5" woofer
- Available in traffic white (RAL 9016)
- EN 54-24:2008 certified

6. CONNECTION

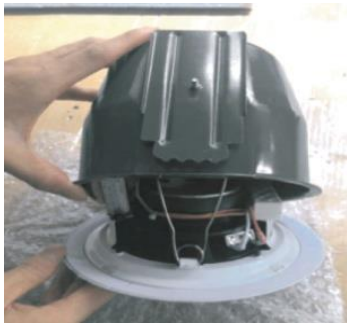

Step A: open the loudspeaker from the clamp as shown in the picture.

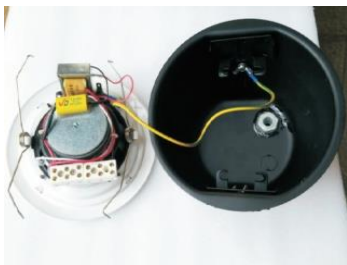

Step B: release the spring to open the fireproof dome.



Step C: pass the audio cable through the wire clamp.

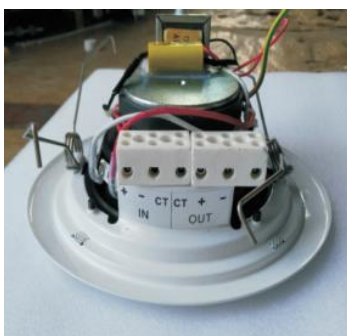

Step D: connect the loudspeaker wire according to the requirement in the label. Then install the loudspeaker.

7. INSTALLATION

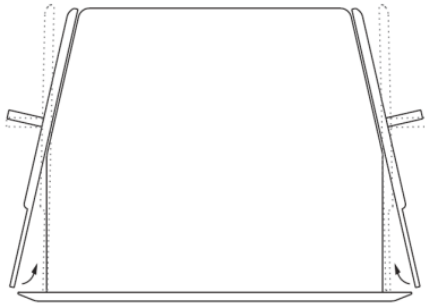

Step 1: measure the mounting hole. It must be as the cut-out size of the device. Pass the cable through the cable gland. Follow steps A, B & C.

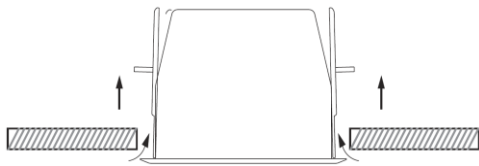

Step 2: loose the metal plates and rise them up to the top. Insert the back can into the mounting hole.

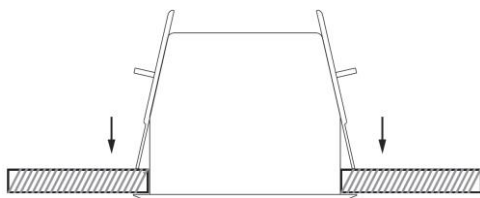

Step 3: slide down the metal plates until they reach the surface. Tight the fasteners inside the back can.

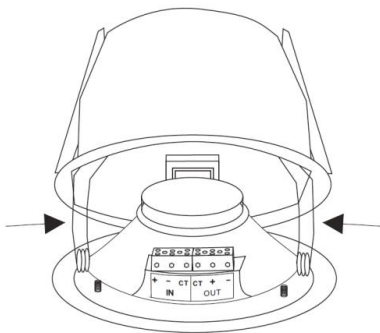

Step 4: follow step D. Then connect the audio cable to the loudspeaker's terminal block. Finally, insert the mounting springs into the hooks and push the loudspeaker into the back can.

8. TECHNICAL DATA

eIC5154

System	
Effective frequency range ¹	120 Hz-20 kHz
Coverage angle ²	165°x165° (HxV)
Sensitivity ³	92 (1W/1m)
Power options	100V: 6W / 3W / 1,5W / 0,75W / 0,38W 70V: 3W / 1,5W / 0,75W / 0,38W / 0,19W
Transducers	
Ways	1
Driver	5" woofer
Physical	
Installation options	Ceiling
Certifications	EN54-24
Enclosure material	ABS
Finished color	Traffic white (RAL 9016)
Recommended cut out diameter	158 mm / 6.22"
Ceiling thickness	No limit min 40mm / 1.57" max
Dimensions (ØxD)	180x157mm / 7.09"x6.18"
Weight	1.2 kg / 2.65 lb

¹10dB below the sound pressure level at specified sensitivity

²6dB below the sound pressure level than that at the direction of maximum level, Average from 1 kHz to 4 kHz.

³Measured on-axis, far field and referenced to 1 meter by inverse square law. Average from 100 Hz to 10 kHz.

Circuit diagram

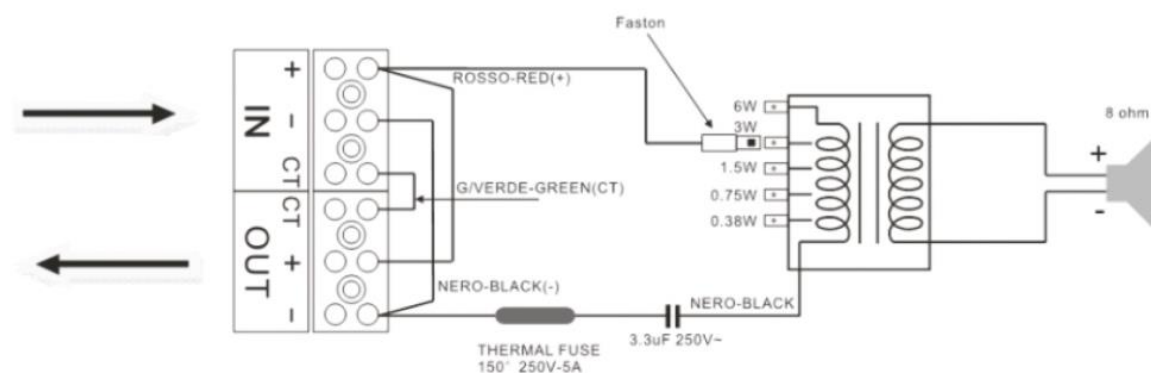

Mechanical diagrams

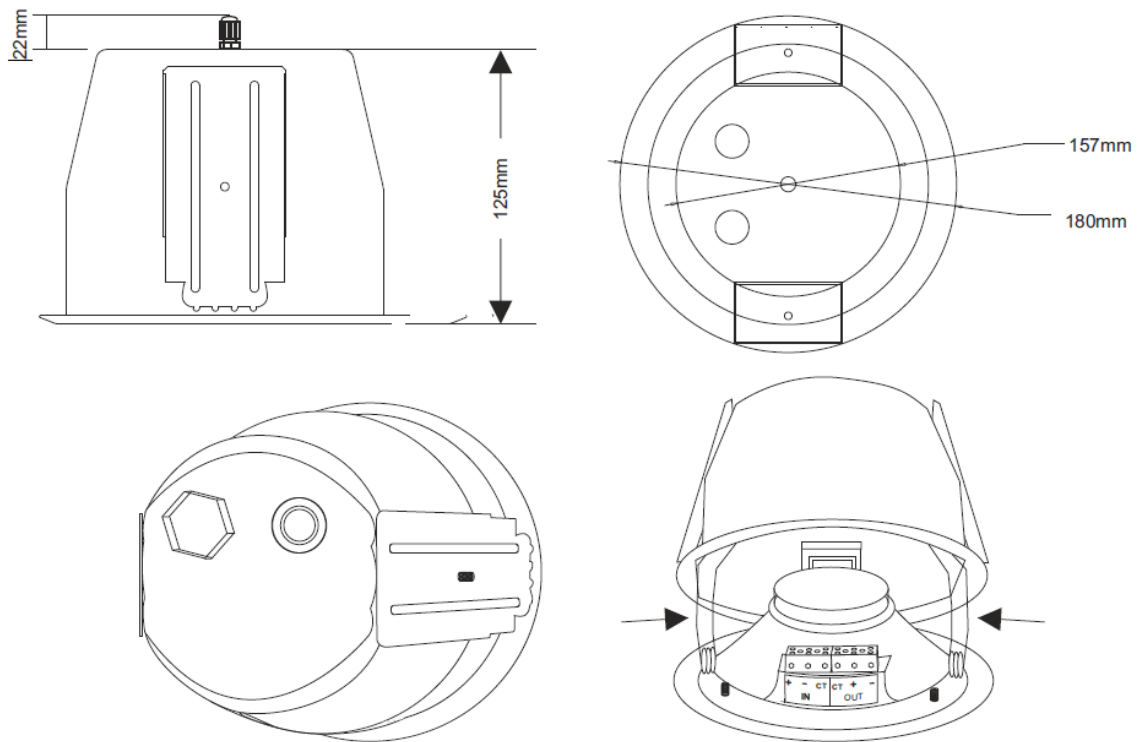

Exploded view

NO.	Name	Specification
1	Speaker shell	5" black Speaker shell
2	Speaker	5" Bass(565EN)
3	Metal film capacitance	250V3.3UF No pole capacitance -25°+85°
4	Transformer	SH-565-1Y
5	Wire clamping device	PG9

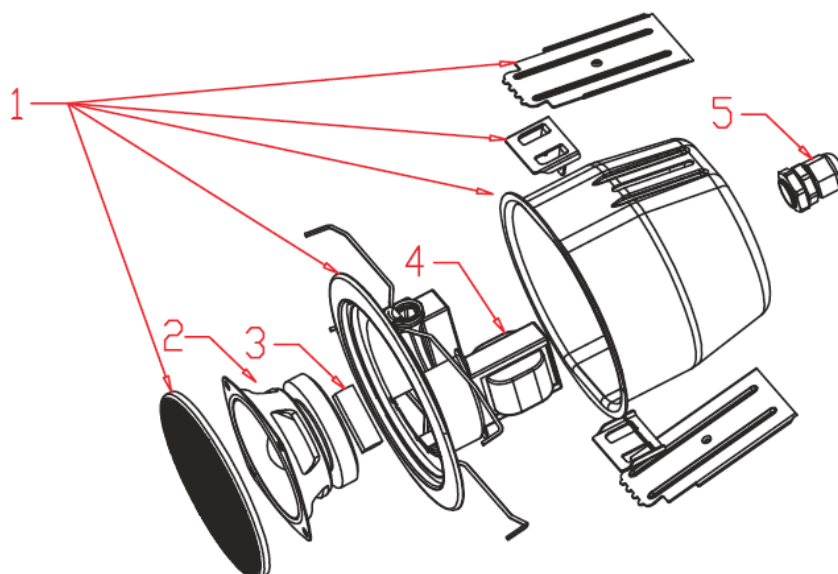

Rear label

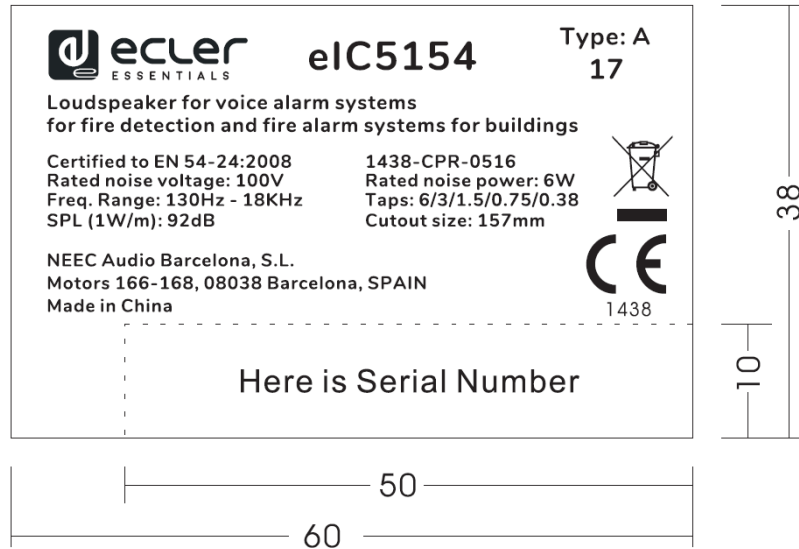

Certification plate

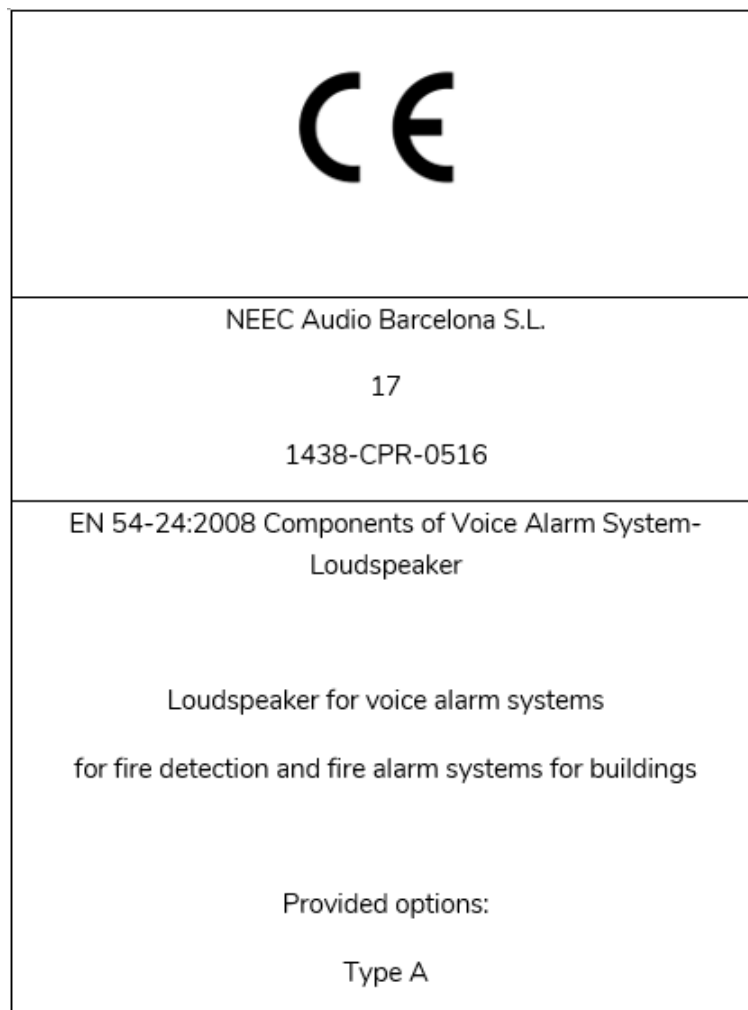



All product characteristics are subject to variation due to production tolerances. **NEEC AUDIO BARCELONA S.L.** reserves the right to make changes or improvements in the design or manufacturing that may affect these product specifications.

For technical queries contact your supplier, distributor or complete the contact form on our website, in [Support / Technical requests](#).

Motors, 166-168 08038 Barcelona - Spain - (+34) 932238403 | information@ecler.com | www.ecler.com