

# IG108

ASSEMBLY AND INSTALLATION  
MONTAGE ET INSTALLATION

MONTAJE E INSTALACIÓN  
MONTAGE UND INSTALLATION

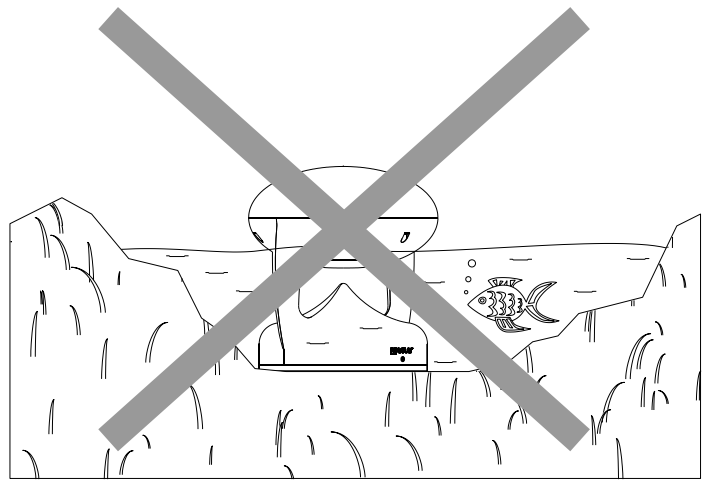
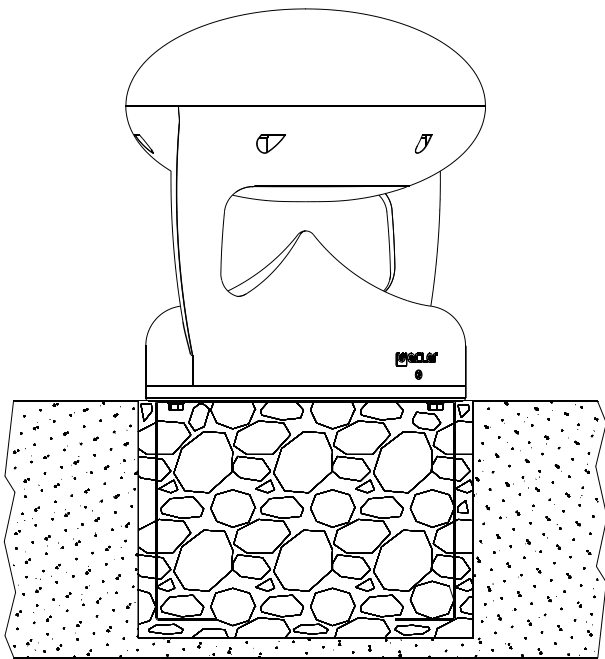
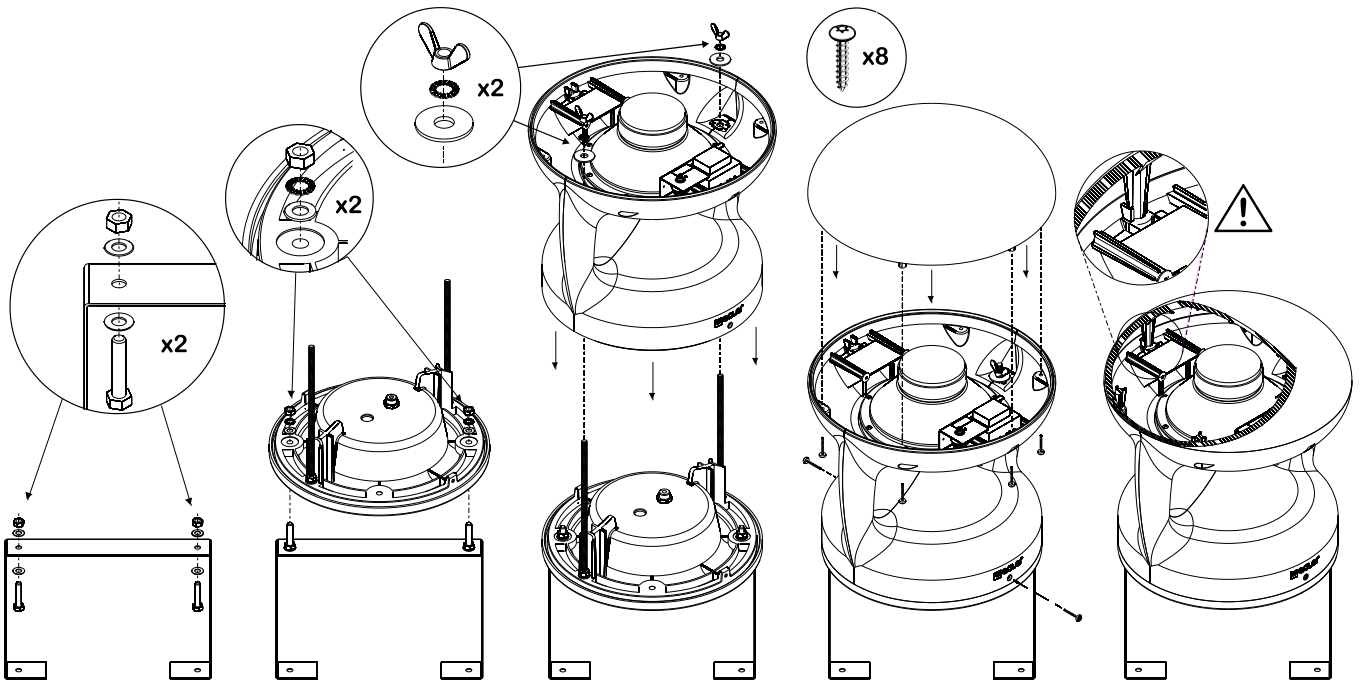

## CONNECTIONS CÂBLAGE

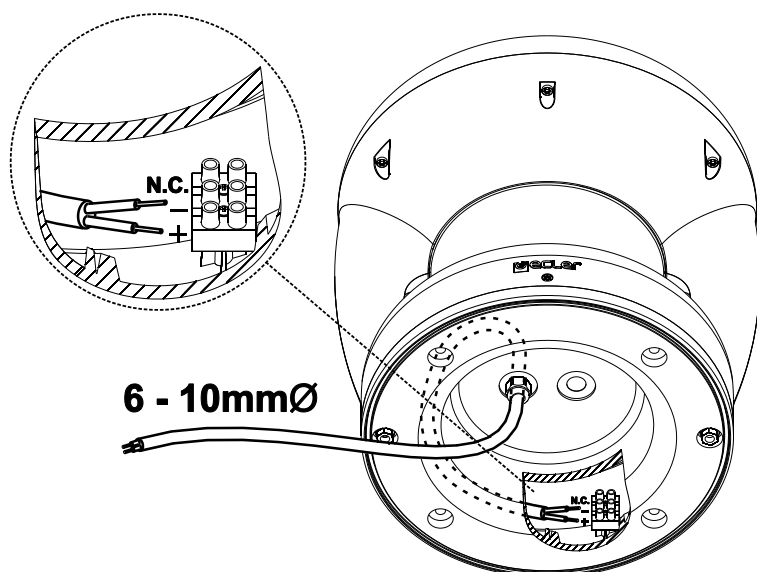

## CONEXIONADO ANSCHLÜSSE

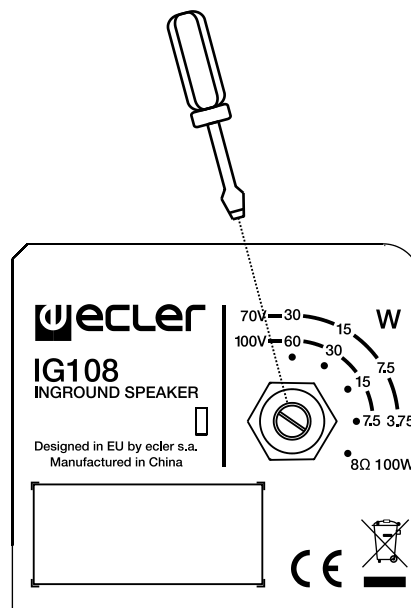

## TECHNICAL CHARACTERISTICS CARACTÉRISTIQUES TECHNIQUES

Ways

2

Nominal low impedance  
Max RMS power  
Program power

8Ω  
100W  
200W

100V Transformer Taps  
70V Transformer Taps

7.5/15/30/60W  
3.75/7.5/15/30W

Efficiency SPL 1W 1m

92dB

Frequency response at -10dB @ 8Ω

50Hz ÷ 23kHz

Dispersion angle

H=360°; V=55°

Recommended covering radius

<8m

Dimensions ØxH (without accessories)

360x392.5mm

Environment

IP65

Operating temperature

-40°C ÷ 70°C

Weight

8.5kg

ECLER Laboratorio de electro-acústica S.A.  
Motors 166-168, 08038 Barcelona, Spain  
INTERNET <http://www.ecler.com> e-mail: [info@ecler.es](mailto:info@ecler.es)

50.0255.01.01