

## DUO-NET PLAYER

### MUSIC SOURCES

*Dual Streaming & Media Audio Player*



### PRODUCT OVERVIEW

ECLER DUO-NET PLAYER is a double audio sound source that features full EclerNet compatibility (EclerNet Manager software, UCP control system, WPmSCREEN remote management, TP-NET third party integration protocol, etc.). It includes 2 independent stereo media players, each one being able to play Internet audio streams and local or networked audio media.

DUO-NET PLAYER can be used as a stand-alone media player or integrated as a piece of a full EclerNet system, as well as coexisting with third-party devices.

### KEY FEATURES

- 2 independent media players, each one linked to a dedicated stereo output
- Compatible with mp3, ogg, AAC, WAV and FLAC audio formats
- SD and USB slots for local storage media contents
- Ethernet interface (RJ45 connector) for EclerNet and TP-NET control, Internet streaming reception and networked media playback
- Fully programmable and controllable via EclerNet software
- UCP (User Control Panels) remote control system, compatible with WPmSCREEN and third-party client devices (iOS®, Windows® and Android®)
- 4 GPI ports (General Purpose Inputs) to trigger events
- IR remote control for basic end-user control
- Priority media (emergency, advertising, etc.) over program audio

### APPLICATIONS

- Audio sound source in A/V corporate, retail and education applications
- BGM & Paging solutions, with message priorities and independent audio source independent selection
- Integration in installation global control systems

### CERTIFICATIONS

- EN60065:2014
- EN55103-1:2009
- EN55103-2:2009
- 2006/95/EC
- 2004/108/CE

MECHANICAL DIAGRAMS

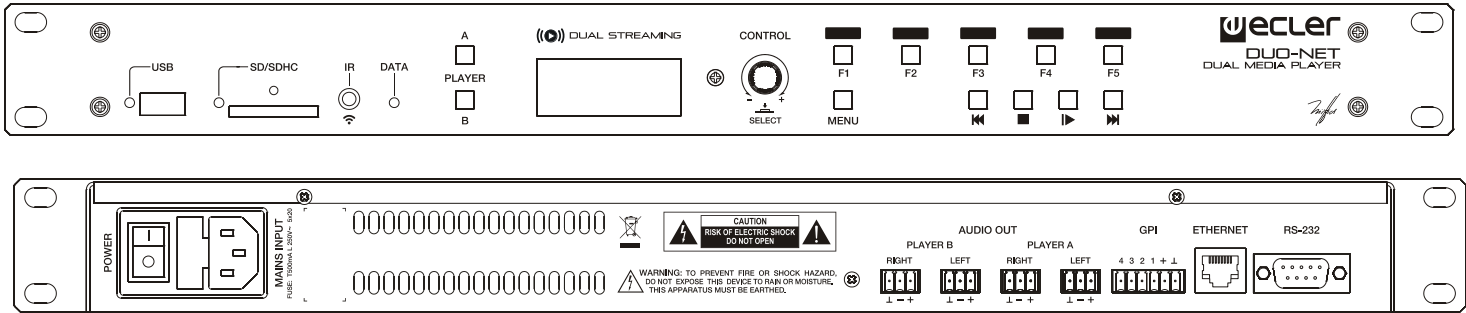

TECHNICAL DATA

ETHERNET	
Connector	RJ45
Speed	10/100Mbps
AUDIO OUTPUT	
Nominal output level	+6dB (balanced) 0db (unbalanced)
Max Output Level/Minimum Load	+12dBV / 5kΩ
Freq. Response	5Hz - 24kHz (-3dB)
Balanced output header	4 x 3 pin terminal block
Output impedance	300Ω
MEDIA PLAYER	
Audio DAC	24bit / 48kHz
Output Noise Floor (FFT)	-100dB (from 20Hz to 20kHz)
THD + Noise	< 0.005% (1kHz, 1Vrms)
Compatible file formats	mp3, ogg, WAV, AAC, FLAC, OPUS
SOURCES	
Network locations (Samba protocol)	
USB content	
SD content	
Internet Radio Streams	
GPI	
Number/input voltage	4 ports / 0 - 10VDC
Output header	6 pin Terminal block
RS232	
SubD female connector 9 pin	TP-net protocol
RTC	
Time and date retention (battery)	240 hours aprox.
RTC accuracy	±1 sec. / day
PANEL	
MATRIX DISPLAY	160x64 pixels
Led indicator	USB, SD, NETWORK, PLAYER A/B, F1-F5, PLAY/PAUSE
Direct buttons	ENCODER, F1-F5, MENU, PREV, NEXT, PLAY, STOP, PLAYER A/B

**SUPPLY**

**AC supply mains voltage** 90-264VCA 50-60Hz

**Power consumption** 15VA

**MECHANICAL**

**Dimensions WxHxD** 482.6x44x120mm

**Weight** 1800gr

**USB and SD card interfaces**

**USB host interface** USB 2.0 High Speed (480 Mbps)  
Supports mass storage class devices (externally powered above 500mA current draw)  
Up to 2TB

**Micro SD card interface** Supports SD ver1.0, SDHC  
Up to 32GB

**FAT and files analysis** Supports FAT16, FAT 32 and VFAT  
Multi-partition up to 1  
65354 playable folders  
65354 playable folders within each folder  
65354 playable files within each folder

**Folder hierarchy** Up to 8 containing the root directory

**Playable extensions** mp3, wav, ogg, aac, flac

**Sorting in alphabetical order** UNICODE  
Up to 100 folders  
Up to 100 files by folder  
(Folders/files over 100 sorted in the FAT order)

**ACCESSORIES SUPPLIED**

**Main power cable, IR remote control unit**

**Remote control battery** 2 x AAA, LR-03 1,5V